



GLOBAL FINISHING SOLUTIONS

# Powder Booths

Non-Recovery Booths  
Cartridge Style Booths  
High Production Booths



# Non-Recovery Powder Booths

GFS' Non-Recovery Powder Booths are a cost-effective, high-performance solution for small batch powder applications. These booths feature an open face design, 3-stage filtration system and a high capacity, low-noise recirculation fan.



Optional  
Pre-coated  
white panels



## 3-Stage Filtration System

Incorporated into GFS Non-Recovery Powder Booths, the 3-Stage Filtration System is highly effective at capturing high volumes of powder dust (with up to 99.9% filter efficiency down to 0.5 micron).

### Booth Features

- Galvanized steel panels
- Heavy-duty, high-capacity, low noise plug fan (rated at 1.5" SP)
- Smooth interior for easy maintenance
- 3-stage filtration system that includes a full set of filters, grids and manometer for filter maintenance
- Energy-efficient, inside-access light fixture(s)
- Recirculates clean air
- Assembly hardware and drawings
- Air make-up not required
- Designed to comply with all federal, OSHA and NFPA regulations

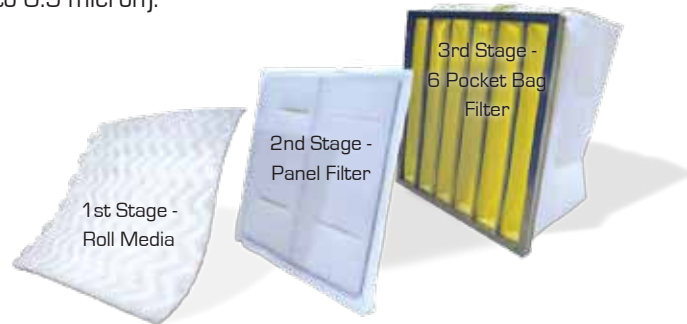

### Options

- White pre-coated panels
- Conveyor openings
- Additional light fixtures
- Booth extensions
- Product doors
- CP1 control panel



# Non-Recovery Powder Booths

## Standard Models

Standard Model No.	Inside Dimensions			Outside Dimensions			Fan Clear Height	Light Qty	CFM	Fan Diameter	Motor HP
	Width	Height	Depth	Width	Height	Depth					
PNRG-080806	8'	8'	6'	8'-4"	8'-2"	10'-2"	12'-2"	1	8000	24"	3
PNRG-080809	8'	8'	9'	8'-4"	8'-2"	13'-2"	12'-2"	1	8000	24"	3
PNRG-080812	8'	8'	12'	8'-4"	8'-2"	16'-2"	12'-2"	2	8000	24"	3
PNRG-081006	8'	10'	6'	8'-4"	10'-2"	10'-2"	14'-2"	1	10000	24"	5
PNRG-081009	8'	10'	9'	8'-4"	10'-2"	13'-2"	14'-2"	1	10000	24"	5
PNRG-081012	8'	10'	12'	8'-4"	10'-2"	16'-2"	14'-2"	2	10000	24"	5
PNRG-100806	10'	8'	6'	10'-4"	8'-2"	10'-2"	12'-2"	2	10000	24"	5
PNRG-100809	10'	8'	9'	10'-4"	8'-2"	13'-2"	12'-2"	2	10000	24"	5
PNRG-100812	10'	8'	12'	10'-4"	8'-2"	16'-2"	12'-2"	4	10000	24"	5
PNRG-101006	10'	10'	6'	10'-4"	10'-2"	10'-2"	14'-11"	2	12500	30"	5
PNRG-101009	10'	10'	9'	10'-4"	10'-2"	13'-2"	14'-11"	2	12500	30"	5
PNRG-101012	10'	10'	12'	10'-4"	10'-2"	16'-2"	14'-11"	4	12500	30"	5
PNRG-120806	12'	8'	6'	12'-4"	8'-10"	10'-2"	12'-11"	2	12000	30"	5
PNRG-120809	12'	8'	9'	12'-4"	8'-10"	13'-2"	12'-11"	2	12000	30"	5
PNRG-120812	12'	8'	12'	12'-4"	8'-10"	16'-2"	12'-11"	4	12000	30"	5
PNRG-121006	12'	10'	6'	12'-4"	10'-10"	10'-2"	14'-11"	2	15000	30"	5
PNRG-121009	12'	10'	9'	12'-4"	10'-10"	13'-2"	14'-11"	2	15000	30"	5
PNRG-121012	12'	10'	12'	12'-4"	10'-10"	16'-2"	14'-11"	4	15000	30"	5
PNRG-140806	14'	8'	6'	14'-4"	8'-10"	10'-2"	12'-11"	2	14000	30"	5
PNRG-140809	14'	8'	9'	14'-4"	8'-10"	13'-2"	12'-11"	2	14000	30"	5
PNRG-140812	14'	8'	12'	14'-4"	8'-10"	16'-2"	12'-11"	4	14000	30"	5
PNRG-141006	14'	10'	6'	14'-4"	10'-10"	10'-2"	15'-4"	2	17500	36"	5
PNRG-141009	14'	10'	9'	14'-4"	10'-10"	13'-2"	15'-4"	2	17500	36"	5
PNRG-141012	14'	10'	12'	14'-4"	10'-10"	16'-2"	15'-4"	4	17500	36"	5
PNRG-160806	16'	8'	6'	16'-4"	8'-10"	10'-2"	12'-11"	2	16000	30"	7.5
PNRG-160809	16'	8'	9'	16'-4"	8'-10"	13'-2"	12'-11"	2	16000	30"	7.5
PNRG-160812	16'	8'	12'	16'-4"	8'-10"	16'-2"	12'-11"	4	16000	30"	7.5
PNRG-161006	16'	10'	6'	16'-4"	10'-10"	10'-2"	15'-4"	2	20000	36"	7.5
PNRG-161009	16'	10'	9'	16'-4"	10'-10"	13'-2"	15'-4"	2	20000	36"	7.5
PNRG-161012	16'	10'	12'	16'-4"	10'-10"	16'-2"	15'-4"	4	20000	36"	7.5
PNRG-180806	18'	8'	6'	18'-4"	8'-10"	10'-2"	13'-4"	3	18000	36"	7.5
PNRG-180809	18'	8'	9'	18'-4"	8'-10"	13'-2"	13'-4"	3	18000	36"	7.5
PNRG-180812	18'	8'	12'	18'-4"	8'-10"	16'-2"	13'-4"	6	18000	36"	7.5
PNRG-181006	18'	10'	6'	18'-4"	10'-10"	10'-2"	15'-4"	3	22500	36"	7.5
PNRG-181009	18'	10'	9'	18'-4"	10'-10"	13'-2"	15'-4"	3	22500	36"	7.5
PNRG-181012	18'	10'	12'	18'-4"	10'-10"	16'-2"	15'-4"	6	22500	36"	7.5
PNRG-200806	20'	8'	6'	20'-4"	8'-10"	10'-2"	13'-4"	4	20000	36"	7.5
PNRG-200809	20'	8'	9'	20'-4"	8'-10"	13'-2"	13'-4"	4	20000	36"	7.5
PNRG-200812	20'	8'	12'	20'-4"	8'-10"	16'-2"	13'-4"	8	20000	36"	7.5
PNRG-201006	20'	10'	6'	20'-4"	10'-10"	10'-2"	15'-4"	4	25000	36"	10
PNRG-201009	20'	10'	9'	20'-4"	10'-10"	13'-2"	15'-4"	4	25000	36"	10
PNRG-201012	20'	10'	12'	20'-4"	10'-10"	16'-2"	15'-4"	8	25000	36"	10

Notes: Motor HP, voltage and phase specific. CFM rating based on clean filters

# Cartridge-Style Powder Booths

Featuring our exclusive PC-100 powder collection modules, GFS' Cartridge-Style Powder Booths are ideal for small to medium powder applications. A self-pulsing system continuously cleans cartridge filters for longer filter life. Unused powder can be reclaimed for future powder application.

## Booth Features

- Galvanized steel panels
- Smooth interior for easy maintenance
- PC-100 powder collection module(s), including:
  - High-efficiency cartridge filters, final filters and air solenoid valve for filter maintenance
  - High-performance direct-drive motor and non-sparking fan
- Standard differential pressure gauge with safety interlock for automatic shut down when air pressure exceeds normal operating range
- Energy-efficient, inside-access light fixture(s)
- Recirculates clean air
- Assembly hardware and drawings
- Air make-up not required
- Designed to comply with all federal, OSHA and NFPA regulations



Optional  
Pre-coated  
white panels

## Options

- White pre-coated panels
- Fluidized bed for powder recovery (pump not included)
- Conveyor openings
- Booth extensions
- Product doors
- Additional light fixtures
- Deluxe control panel with Photohelic pressure gauge that monitors pressure drop and initiates pulse-jet filter cleaning



## PC-100 - Collector Module Only

Included in GFS Cartridge-Style Powder Booths or sold separately

- 5 HP direct drive, 3-phase 208/230-460V motor with non-sparking fan
- 6 cartridge filters for fast release mounting assembly
- 4 final filters for additional protection
- Air supply requirements are 2.3 cfm @ 40-70 psig or 13.1 scfm per module; regulator not included
- Optional casters for tracks or roll around



Standard Filter  
Part No:  
216-203  
8" x 26" - Cartridge Filter  
216-011  
20" x 20" x 2" - Final Filter

PC-100 Modules	Overall Dimensions			Equipment Clearance Dim.		
	Width	Height	Depth	Width	Height	Depth
PC-100	4'	8' - 2"	3'	4'	8' - 7 7/8"	4' - 2"

# Cartridge-Style Powder Booths

## Standard Models

Standard Model No.	Inside Dimensions			Outside Dimensions			Collector QTY	Max SCFM	Light QTY	Optional Control Panel
	Width	Height	Depth	Width	Height	Depth				
PCBG-060806	6'	8'	6'	6'-4"	8'-2"	10'-2"	1	5,000	1	CP1-PCB
PCBG-060809	6'	8'	9'	6'-4"	8'-2"	13'-2"	1	5,000	1	CP1-PCB
PCBG-060812	6'	8'	12'	6'-4"	8'-2"	16'-2"	1	5,000	2	CP1-PCB
PCBG-061006	6'	10'	6'	6'-4"	10'-2"	10'-2"	1	5,000	1	CP1-PCB
PCBG-061009	6'	10'	9'	6'-4"	10'-2"	13'-2"	1	5,000	1	CP1-PCB
PCBG-061012	6'	10'	12'	6'-4"	10'-2"	16'-2"	1	5,000	2	CP1-PCB
PCBG-080806	8'	8'	6'	8'-4"	8'-2"	10'-2"	2	10,000	1	CP2-PCB
PCBG-080809	8'	8'	9'	8'-4"	8'-2"	13'-2"	2	10,000	1	CP2-PCB
PCBG-080812	8'	8'	12'	8'-4"	8'-2"	16'-2"	2	10,000	2	CP2-PCB
PCBG-081006	8'	10'	6'	8'-4"	10'-2"	10'-2"	2	10,000	1	CP2-PCB
PCBG-081009	8'	10'	9'	8'-4"	10'-2"	13'-2"	2	10,000	1	CP2-PCB
PCBG-081012	8'	10'	12'	8'-4"	10'-2"	16'-2"	2	10,000	2	CP2-PCB
PCBG-100806	10'	8'	6'	10'-4"	8'-2"	10'-2"	2	10,000	2	CP2-PCB
PCBG-100809	10'	8'	9'	10'-4"	8'-2"	13'-2"	2	10,000	2	CP2-PCB
PCBG-100812	10'	8'	12'	10'-4"	8'-2"	16'-2"	2	10,000	4	CP2-PCB
PCBG-101006	10'	10'	6'	10'-4"	10'-2"	10'-2"	2	10,000	2	CP2-PCB
PCBG-101009	10'	10'	9'	10'-4"	10'-2"	13'-2"	2	10,000	2	CP2-PCB
PCBG-101012	10'	10'	12'	10'-4"	10'-2"	16'-2"	2	10,000	4	CP2-PCB
PCBG-120806	12'	8'	6'	12'-4"	8'-10"	10'-2"	2	10,000	2	CP2-PCB
PCBG-120809	12'	8'	9'	12'-4"	8'-10"	13'-2"	2	10,000	2	CP2-PCB
PCBG-120812	12'	8'	12'	12'-4"	8'-10"	16'-2"	2	10,000	4	CP2-PCB
PCBG-121006	12'	10'	6'	12'-4"	10'-10"	10'-2"	2	10,000	2	CP2-PCB
PCBG-121009	12'	10'	9'	12'-4"	10'-10"	13'-2"	2	10,000	2	CP2-PCB
PCBG-121012	12'	10'	12'	12'-4"	10'-10"	16'-2"	2	10,000	4	CP2-PCB
PCBG-140806	14'	8'	6'	14'-4"	8'-10"	10'-2"	2	10,000	2	CP2-PCB
PCBG-140809	14'	8'	9'	14'-4"	8'-10"	13'-2"	2	10,000	2	CP2-PCB
PCBG-140812	14'	8'	12'	14'-4"	8'-10"	16'-2"	2	10,000	4	CP2-PCB
PCBG-141006	14'	10'	6'	14'-4"	10'-10"	10'-2"	3	15,000	2	CP3-PCB
PCBG-141009	14'	10'	9'	14'-4"	10'-10"	13'-2"	3	15,000	2	CP3-PCB
PCBG-141012	14'	10'	12'	14'-4"	10'-10"	16'-2"	3	15,000	4	CP3-PCB
PCBG-160806	16'	8'	6'	16'-4"	8'-10"	10'-2"	3	15,000	2	CP3-PCB
PCBG-160809	16'	8'	9'	16'-4"	8'-10"	13'-2"	3	15,000	2	CP3-PCB
PCBG-160812	16'	8'	12'	16'-4"	8'-10"	16'-2"	3	15,000	4	CP3-PCB
PCBG-161006	16'	10'	6'	16'-4"	10'-10"	10'-2"	3	15,000	2	CP3-PCB
PCBG-161009	16'	10'	9'	16'-4"	10'-10"	13'-2"	3	15,000	2	CP3-PCB
PCBG-161012	16'	10'	12'	16'-4"	10'-10"	16'-2"	3	15,000	4	CP3-PCB
PCBG-180806	18'	8'	6'	18'-4"	8'-10"	10'-2"	3	15,000	3	CP3-PCB
PCBG-180809	18'	8'	9'	18'-4"	8'-10"	13'-2"	3	15,000	3	CP3-PCB
PCBG-180812	18'	8'	12'	18'-4"	8'-10"	16'-2"	3	15,000	6	CP3-PCB
PCBG-181006	18'	10'	6'	18'-4"	10'-10"	10'-2"	3	15,000	3	CP3-PCB
PCBG-181009	18'	10'	9'	18'-4"	10'-10"	13'-2"	3	15,000	3	CP3-PCB
PCBG-181012	18'	10'	12'	18'-4"	10'-10"	16'-2"	3	15,000	6	CP3-PCB
PCBG-200806	20'	8'	6'	20'-4"	8'-10"	10'-2"	4	20,000	4	CP4-PCB
PCBG-200809	20'	8'	9'	20'-4"	8'-10"	13'-2"	4	20,000	4	CP4-PCB
PCBG-200812	20'	8'	12'	20'-4"	8'-10"	16'-2"	4	20,000	8	CP4-PCB
PCBG-201006	20'	10'	6'	20'-4"	10'-10"	10'-2"	4	20,000	4	CP4-PCB
PCBG-201009	20'	10'	9'	20'-4"	10'-10"	13'-2"	4	20,000	4	CP4-PCB
PCBG-201012	20'	10'	12'	20'-4"	10'-10"	16'-2"	4	20,000	8	CP4-PCB

# High Production Powder Booths

Often used in conveyorized powder application systems, GFS' High Production Powder Booths are designed to increase productivity, product quality and profitability. Modular designs engineered for optimum airflow and maximum transfer efficiency make these booths ideal for any high production powder coating application.

## Booth Features

- 18-gauge, stainless steel panels for exceptionally long life
- Smooth, tapered inside surfaces for easy cleaning
- Standard 2-foot long entrance and exit vestibules
- Transparent, polycarbonate ceiling for brighter application environment
- Adjustable height leveling
- Overhead filtration with lightweight removable filter modules
- Independent, self-cleaning powder collection module(s), including:
  - High-efficiency cartridge filters, final filters and air solenoid valve for filter maintenance
  - High-performance motor and recirculation fan
  - Fluidized bed
  - Integral powder fill hopper
  - Casters for easy maneuverability during color changes
- Deluxe control panel with Photohelic pressure gauge that monitors pressure drop and initiates pulse-jet filter cleaning
- Designed to comply with all federal, OSHA and NFPA regulations



Custom designed booth openings such as operator shields and touch-up windows create a safe and efficient working environment.



## Options

- Booth openings
- Central air manifold with required regulators
- 2-speed fan control with operating and cleaning modes
- Roll on/off track system
- Flame detection system
- Fluorescent lighting

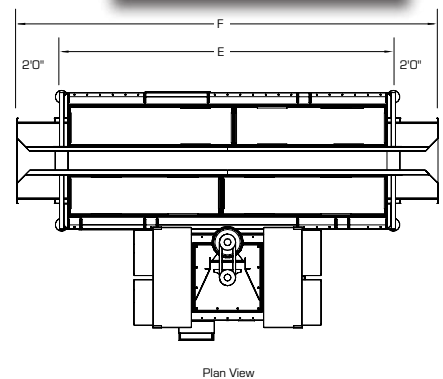
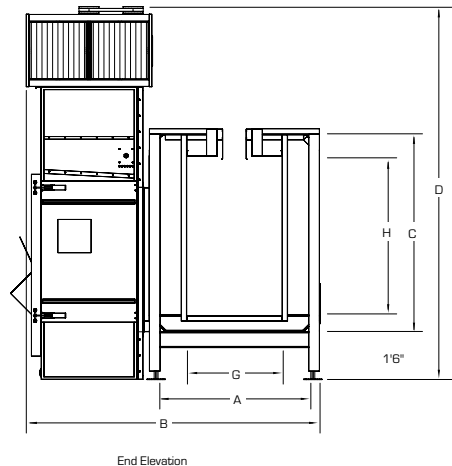

Model No.	Inside Dimensions			Overall Dimensions			Conveyor Openings		Auto. Gun Slots		Operator Windows		Collector Module				
	Width A	Height C	Length E	Width B	Height D	Length F	Width G	Height H	Qty	Height	Qty	Width	Height	CFM	Fan Size	Fan HP	Filter Qty
HPCB-2436	4'-0"	5'-0"	14'-6"	8'-9"	11'-5"	18'-6"	2'-0"	3'-0"	2	3'-0"	2	2'-6"	3'-0"	4,000	18"	5	6
HPCB-2448	4'-0"	6'-0"	14'-6"	8'-9"	11'-5"	18'-6"	2'-0"	4'-0"	2	4'-0"	2	2'-6"	4'-0"	5,000	18"	7.5	8
HPCB-3060	5'-0"	7'-0"	16'-6"	9'-9"	11'-5"	20'-6"	2'-6"	5'-0"	2	4'-0"	2	2'-6"	4'-0"	6,000	20"	7.5	10
HPCB-3660	5'-0"	7'-0"	16'-6"	9'-9"	11'-5"	20'-6"	3'-0"	5'-0"	2	5'-0"	2	2'-6"	5'-0"	7,000	22"	10	10
HPCB-3672	5'-0"	8'-0"	18'-6"	9'-9"	11'-5"	22'-6"	3'-0"	6'-0"	2	5'-0"	2	2'-6"	5'-0"	8,000	22"	10	12
HPCB-4872	6'-0"	8'-0"	18'-6"	10'-9"	11'-5"	22'-6"	4'-0"	6'-0"	2	5'-0"	2	2'-6"	5'-0"	9,000	22"	15	12

# Parts & Filters Department

GFS offers a full line of replacement parts, filters and paint booth accessories. We supply parts and filters for all of our current and legacy products, as well as products from Binks Booths, Blu-Surf Systems, DeVilbiss Booths, JBI Booths and Ovens, Milbanks Systems and other spray booth manufacturers.

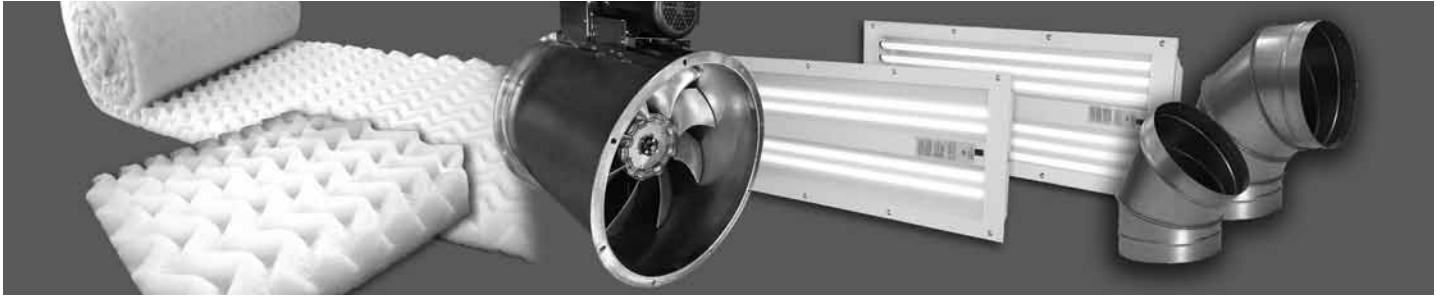

Great emphasis is placed on engineering and workmanship so that you receive the best products at competitive prices.

- Control Panels
- Fans
- Hardware
- Motors
- Doors
- Filters
- Insulation
- Oven Components
- Ductwork
- Filter Racks
- Lighting
- Spray Booth Accessories
- Electrical Components
- Grates and Pans
- Miscellaneous Parts
- Replacement Panels

A full-service Parts & Filters Department is dedicated to providing top-quality replacement parts sourced from suppliers and kept in stock for quick turnaround and fast shipping to virtually any location across North America and the world.



**CONTACT GFS FOR MORE INFORMATION 800-8488738**





## GLOBAL FINISHING SOLUTIONS

All designs, specifications and components are subject to change at the manufacturer's sole discretion at any time without notice. Data published herein is informational in nature and shall not be construed to warrant suitability of the unit for any particular purpose as performance may vary with the conditions encountered.



Use your smart phone  
to visit our website:

[www.globalfinishing.com](http://www.globalfinishing.com) • 800-848-8738 • [industrial@globalfinishing.com](mailto:industrial@globalfinishing.com)

©2013 Global Finishing Solutions. All Rights Reserved.

Follow GFS: [facebook.com/globalfinishing](https://www.facebook.com/globalfinishing) [twitter.com/globalfinishing](https://www.twitter.com/globalfinishing)

POWDER 04292013