



AVX

Automatic Airmix[®] Spray Gun

Lightweight and versatile for efficient production

Product highlights

- High transfer efficiency - up to 86%
- Excellent atomization quality
- Modular design and high reliability



BOND • PROTECT • BEAUTIFY

AVX

Automatic Airmix® Spray Gun

The automatic Airmix® AVX spray gun ensures high level performance with unsurpassed finish & excellent atomization quality. The base-mounted modular design allows for quick maintenance with minimum downtime.



Adapted industrial markets

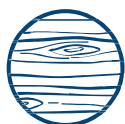

Wood



Transportation



Industrial



ACE*



Railways



Technical data table

Designation	Value	Unit
Maximum Air Pressure	6 (87)	bar (psi)
Trigger Air Pressure	3 (43)	bar (psi)
Recommended Air Pressure	0.7 - 3 (10 - 43)	bar (psi)
Optimal Transfer Efficiency	86	%
Pilot Air Inlet	F 1/8 NPS (base) or FF4x6 (fittings)	
Atomizing Air Inlet	F 1/4 NPS (base) or M1/4 NPS (fittings)	
Maximum Material Pressure	200 (2900)	bar (psi)
Minimum Material Pressure	20 (290)	bar (psi)
Air Consumption	3 - 7.5 (1.77 - 4.41)	m3/h (cfm)
Weight	(16)	kg (lbs)
Maximum Temperature	50 (122)	°C (°F)
Certification	CE-UKCA II2G Ex h IIB T6 Gb X	
HVLP Compliant	Yes	
Compatible spray tip	Airmix® Asymmetrical Airmix® Fine Finish Airmix® Xtra Fine Finish	
Additional Technical characteristics	The fluid output is determined by the tip used	
Material Inlet Port	2 x F 1/4 NPS (base) or 2 x M1/2" JIC (fittings)	
Wetted Parts	Stainless steel 303, PTFE	
Body Material	Aluminium	
Maximum Fluid Temperature	50 (122)	°C (°F)

Marking

Product	Type
AVX	CE 0080  2503  CE-UKCA II2G Ex h IIB T6 Gb X

*: "AgricultureConstruction and Earthmoving"



Technologies



Airmix® spray technology



GT sealing



Description

Leading spray technology since 1975, Airmix® technology was invented by Sames to reduce paint consumption, reduce cost of ownership, increase productivity, improve working conditions, and preserve the environment. Continuously improved over the past 35 years, Airmix® is today the most efficient non-electrostatic spray technology providing up to 86% transfer efficiency.

As a result, most automatic machine manufacturers using medium fluid pressure atomization have adopted Sames Airmix® automatic guns because they are reliable, deliver outstanding finish quality, and their simple construction minimizes the cost of servicing and downtime.

The AVX automatic spray gun, mounted on a base, has a compact and lightweight design and simple construction with a limited number of parts. Built with premium materials, this automatic sprayer is very reliable and brings reduced cost of ownership. The circulation can be done in the gun for quicker and better flushing with a limited volume of solvent sprayed into the machine or spray booth or in the base to reduce pressure loss in circulation systems.

Performances

1 - Dual spring mounted outside fluid passage allows for opening air before atomizing fluid for better fan spray quality

2 - VX24 (adjustable spray) or VX124 (fixed spray) and a wide offering of fine finish and Xtra fine finish spray tips

3 - Optional fan air - local or remote control

- Extreme film build accuracy
- Compatible with a wide range of products (solvent-based and water-based)

Productivity

4 - Easy assembly and disassembly - Only 4 bolts for easy servicing

Circulation in the base allows less pressure loss in circulation system

OR Circulation in the gun offers a quicker, better flushing with limited volume of solvent sprayed into the machine or spray booth

Sustainability

5 - Wetted parts are stainless steel, Rulon or GT for better durability

- Extended lifetime with most products

2 - % according to EN 13966-1 norm

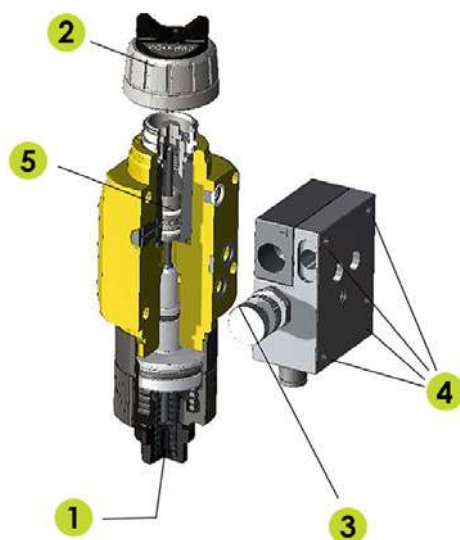

Kits

Designation	Part number
Complete AVX () with side outputs base & fittings	129695000
Complete AVX () with rear outputs base & fittings	129695050
Complete AVX (Omega) with side outputs base & fittings	129695100
Complete AVX (Omega) with rear outputs base & fittings	129695150
Complete AVX () with side outputs Cefla base & fittings	129695200

Accessories

Designation	Part number
Mounting rod Dia16 + nut Dia16	029253002
Mounting rod Dia16 + nut Dia16	049351000
Mounting support DIA. 12mm	049351700
Mounting rod Dia16 + nut Dia16	0493510705
Manual air adjuster (M14*100)	129253100
ACETAL SEAT (PACK OF 10)	129679904
Package of Seals AVX (Air and Fluid)	129690901
AIRCAP VX54	132670030
AIRCAP VX14 - HVLP	132670920
AIRCAP VX114 - HVLP	132670940
Aircap protection (pack of 3)	132720003
VX24 KHVLP - Xcite®+ type ring	132720020
AIRCAP VX124 - HVLP	132720055
AIRCAP VX124 - HVLP (MVX ring)	132720065

Spare parts

Designation	Part number
6 UNCLOGGING NEEDLES - 06 09 TIP (1 BOX)	000094000
6 UNCLOGGING NEEDLES - 09 & OVER (1 BOX)	000094002
Stainless steel seat with seal acetal (2 seats and 2 seals)	129679905
Chevron Needle-cartridge assembly (pack of 4)	129690050
GT Needle-cartridge assembly (one)	129690060
ACETAL SEAT (PACK OF 10)	129693907

Equipment

Designation	Part number
AVX Spray Gun (T) (Gun only)	129690000
AVX Spray Gun (T), GT (Gun only)	129690003
() BASE WITH SIDE FLUID CONNEC.	129690070
FLUID FITTING KIT (JIC) FOR SIDE OUTLET BASE	129690075
() BASE WITH REAR FLUID CONNEC.	129690080
FLUID FITTING KIT (JIC) FOR REAR OUTLET BASE	129690085
() CEFLA BASE WITH SIDE FLUID CONNEC.	129690090
Fitting kit for side outlet base Cefla	129690065
AVX Spray Gun (Ω) (Gun only)	129691000
AVX Spray Gun (Ω), GT (Gun only)	129691001
(Omega) BASE WITH SIDE FLUID CONNEC.	129691070
(Omega) BASE WITH REAR FLUID CONNEC.	129691080



Additional information

- User manual
- Spare parts
- Accessories
- Documents
- Videos

